

NOTE:
 This preliminary layout has been completed in accordance with the instructions provided by 17 The Evans Trust. In this respect preliminary desktop data has been used to form this layout. The final layout is subject to the completion of a detailed survey & engineering plans. Accordingly, the conclusions reached within this report may be modified by the author upon the completion of the final design plans & site inspection. Newton Denny Chapelle accepts no responsibility for any loss or damage suffered, however so arising, to any person or corporation who may use or rely on this report.

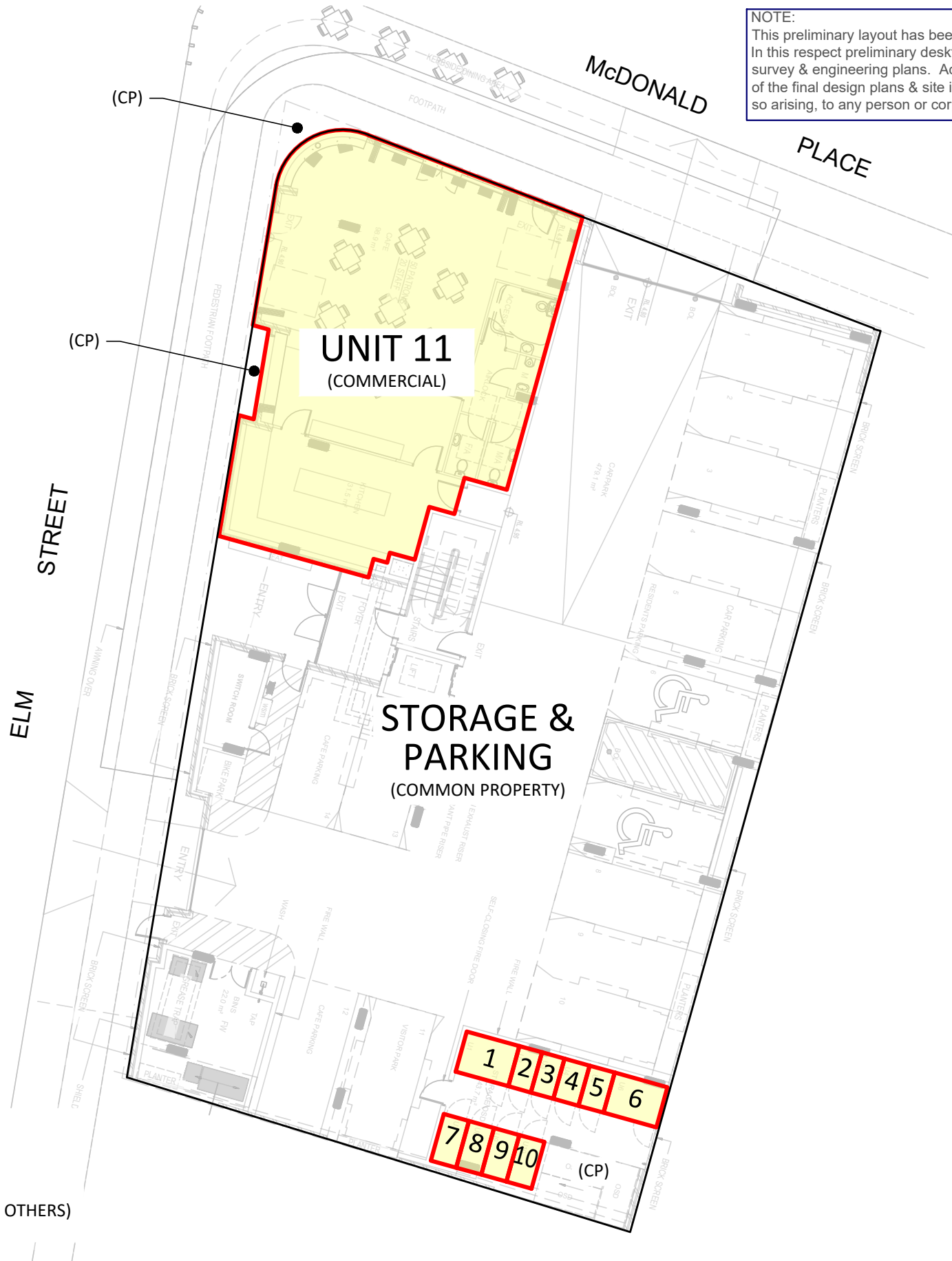

UNIT AREA (APPROX)

UNIT NUMBER	AREA	TOTAL UNIT AREA
UNIT 1 - STORAGE	(3m ²)	179m ²
UNIT 2 - STORAGE	(1m ²)	81m ²
UNIT 3 - STORAGE	(1m ²)	80m ²
UNIT 4 - STORAGE	(1m ²)	148m ²
UNIT 5 - STORAGE	(1m ²)	119m ²
UNIT 6 - STORAGE	(3m ²)	179m ²
UNIT 7 - STORAGE	(1m ²)	81m ²
UNIT 8 - STORAGE	(1m ²)	80m ²
UNIT 9 - STORAGE	(1m ²)	148m ²
UNIT 10 - STORAGE	(1m ²)	119m ²
UNIT 11 - COMMERCIAL	161m ²	161m ²

LEGEND

- PROPOSED STRATA BOUNDARY
- PROPOSED BUILDING
- BUILDING LAYOUT (INDICATIVE - BY OTHERS)
- PROPOSED COMMON PROPERTY

GROUND FLOOR

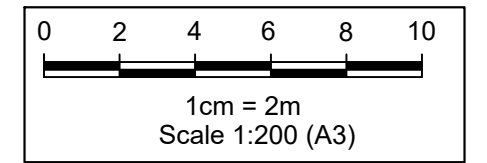

REV	DATE	AMENDMENT
B		
C		
D		
E		

SOURCE PLAN: www.maps.six.nsw.gov.au - accessed
 k:\jobs\2022\220269 - 17 the evans Pty Ltd atf 17 the evans trust\planning\planning plans\ndc plans\cad files\220269-pl-01-proposed strata.dwg - plan 3 - ground floor
 Document Set ID: 1923976
 Version: 1, Version Date: 07/05/2024

ndc
 Newton Denny Chapelle
 Surveyors Planners Engineers
 Email: office@ndc.com.au
 LISMORE 31 Carrington St. Lismore 2480 PH: 6622 1011
 CASUARINA Shop 8/480 Casuarina Way, Casuarina 2487
 ABN: 86 220 045 469

PLAN 3 - GROUND FLOOR (UNIT 11, STORAGE & PARKING)
 CLIENT: 17 THE EVANS TRUST
 LOCATION: LOT 7 IN DP14089
 No.17 McDONALD PLACE
 EVANS HEAD NSW
 DATE: 30/11/2023 REF: 220269-PL-AS-01
 SCALE: 1:200 @ A3 DRAWN: CD

© NEWTON DENNY CHAPELLE

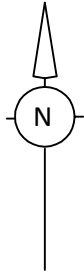

NOTE:
 This preliminary layout has been completed in accordance with the instructions provided by 17 The Evans Trust. In this respect preliminary desktop data has been used to form this layout. The final layout is subject to the completion of a detailed survey & engineering plans. Accordingly, the conclusions reached within this report may be modified by the author upon the completion of the final design plans & site inspection. Newton Denny Chapelle accepts no responsibility for any loss or damage suffered, however so arising, to any person or corporation who may use or rely on this report.

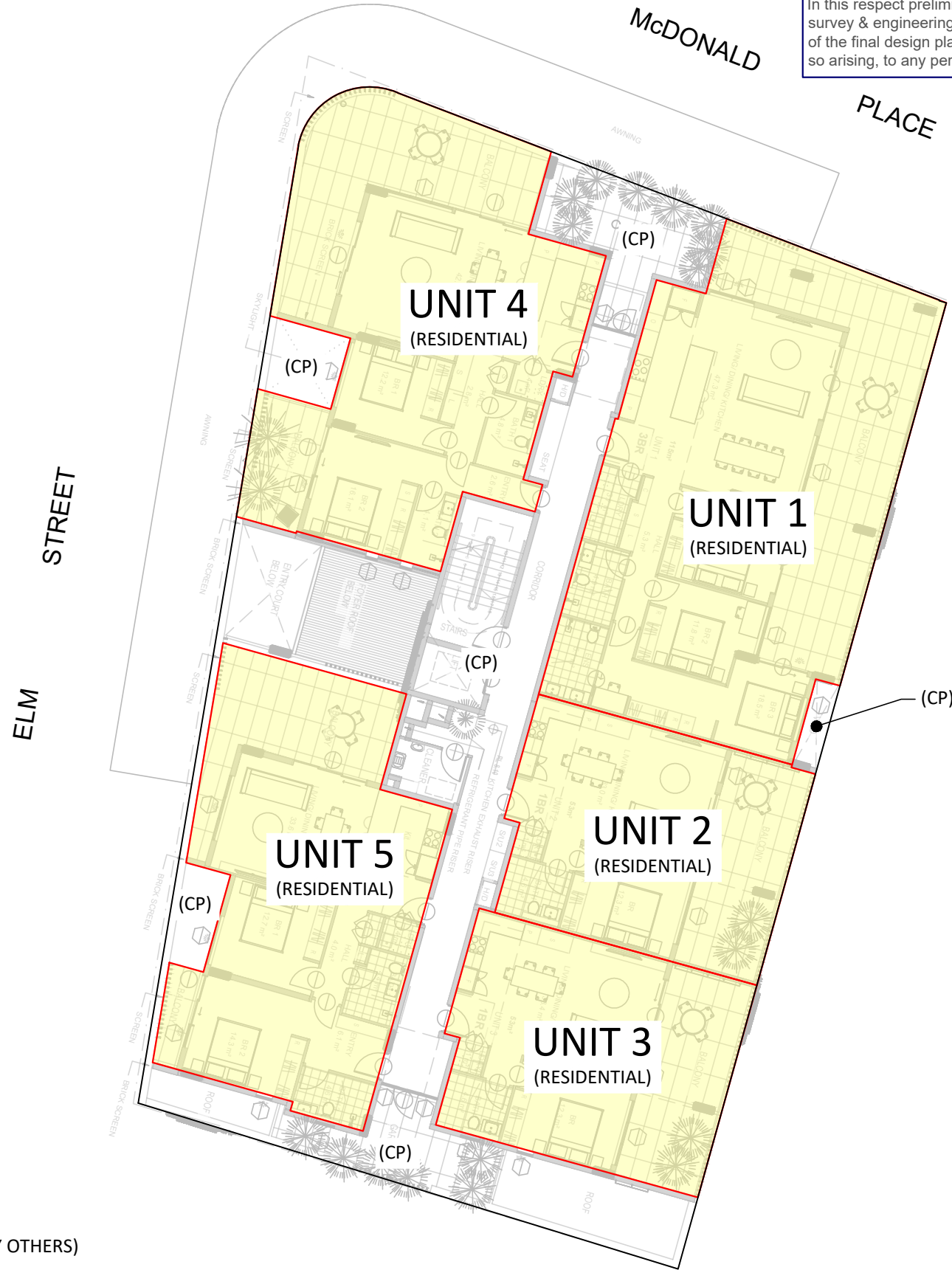

UNIT AREA (APPROX)

UNIT NUMBER	AREA
UNIT 1	176m ²
UNIT 2	80m ²
UNIT 3	79m ²
UNIT 4	147m ²
UNIT 5	118m ²

LEGEND

- PROPOSED STRATA BOUNDARY
- PROPOSED BUILDING
- BUILDING LAYOUT (INDICATIVE - BY OTHERS)
- (CP) PROPOSED COMMON PROPERTY

FIRST FLOOR

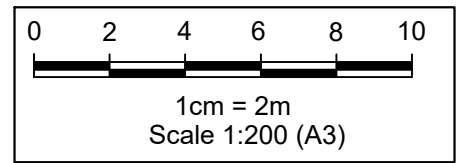

REV	DATE	AMENDMENT
B		
C		
D		
E		

SOURCE PLAN: www.maps.six.nsw.gov.au - accessed
 k:\jobs\2022\220269 - 17 the evans Pty Ltd atf 17 the evans trust\planning\planning plans\ndc plans\cad files\220269-pl-01-proposed strata.dwg - plan 4 - first floor (units 1 - 5)

NDC
 Newton Denny Chapelle
 Surveyors Planners Engineers
 Email: office@ndc.com.au
 LISMORE 31 Carrington St. Lismore 2480 PH: 6622 1011
 CASUARINA Shop 8/480 Casuarina Way, Casuarina 2487
 ABN: 86 220 045 469

PLAN 4 - FIRST FLOOR (UNITS 1 - 5)

CLIENT: 17 THE EVANS TRUST
 LOCATION: LOT 7 IN DP14089
 No.17 McDONALD PLACE
 EVANS HEAD NSW
 DATE: 30/11/2023 REF: 220269-PL-AS-01
 SCALE: 1:200 @ A3 DRAWN: CD

© NEWTON DENNY CHAPELLE

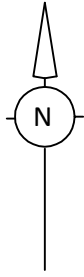

NOTE:
 This preliminary layout has been completed in accordance with the instructions provided by 17 The Evans Trust. In this respect preliminary desktop data has been used to form this layout. The final layout is subject to the completion of a detailed survey & engineering plans. Accordingly, the conclusions reached within this report may be modified by the author upon the completion of the final design plans & site inspection. Newton Denny Chapelle accepts no responsibility for any loss or damage suffered, however so arising, to any person or corporation who may use or rely on this report.

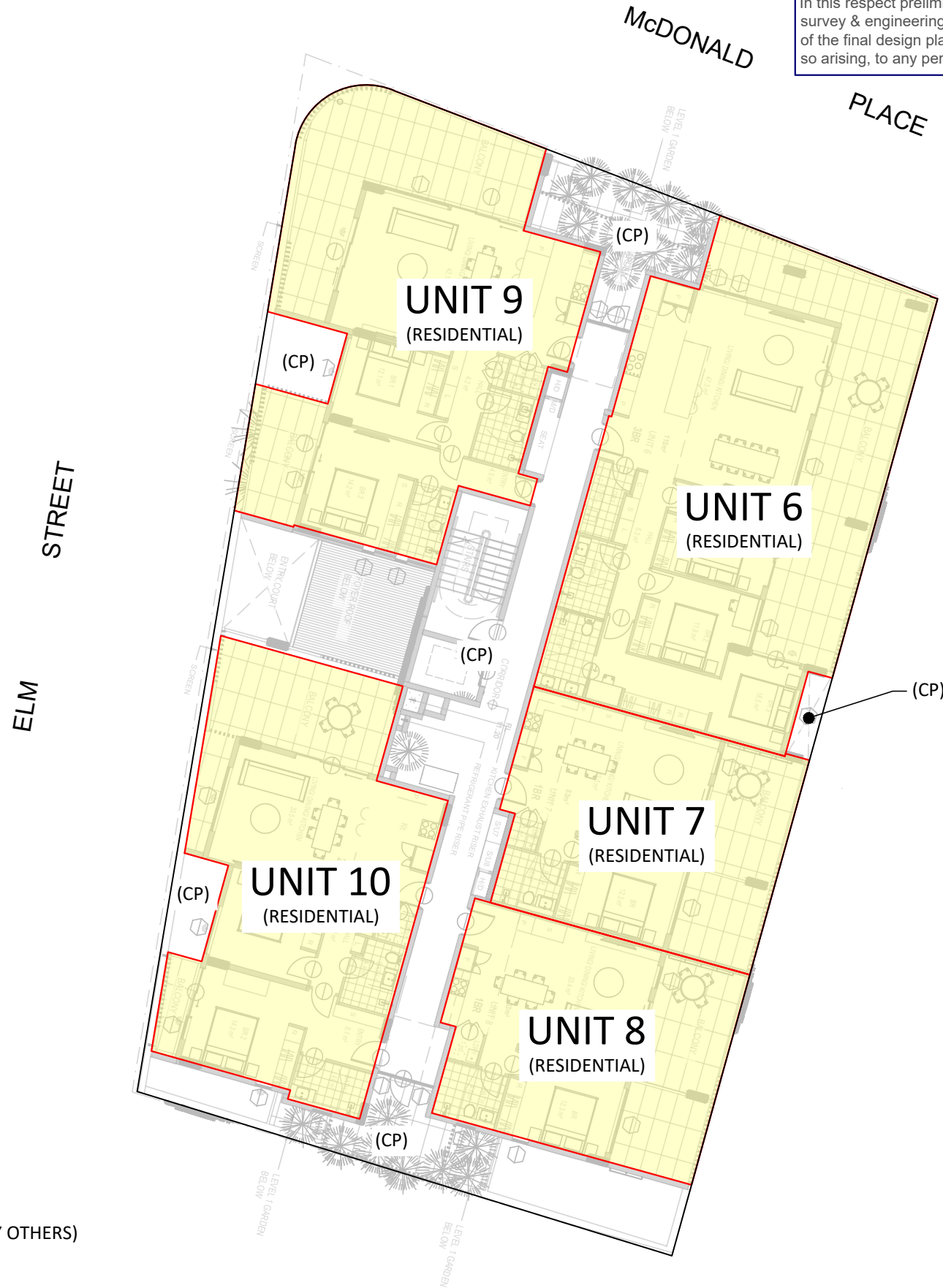

UNIT AREA (APPROX)

UNIT NUMBER	AREA
UNIT 6	176m ²
UNIT 7	80m ²
UNIT 8	79m ²
UNIT 9	147m ²
UNIT 10	118m ²

LEGEND

- PROPOSED STRATA BOUNDARY
- PROPOSED BUILDING
- BUILDING LAYOUT (INDICATIVE - BY OTHERS)
- (CP) PROPOSED COMMON PROPERTY

SECOND FLOOR

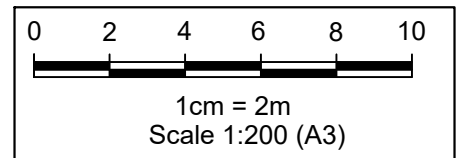

REV	DATE	AMENDMENT
B		
C		
D		
E		

SOURCE PLAN: www.maps.six.nsw.gov.au - accessed
 k:\jobs\2022\220269 - 17 the evans Pty Ltd atf 17 the evans trust\planning\planning plans\ndc plans\cad files\220269-pl-01-proposed strata.dwg - plan 5 - second floor (units 6 - 10)

NDC
 Newton Denny Chapelle
 Surveyors Planners Engineers
 Email: office@ndc.com.au
 LISMORE 31 Carrington St. Lismore 2480 PH: 6622 1011
 CASUARINA Shop 8/480 Casuarina Way, Casuarina 2487
 ABN: 86 220 045 469

PLAN 5 - SECOND FLOOR (UNITS 6 - 10)
 CLIENT: 17 THE EVANS TRUST
 LOCATION: LOT 7 IN DP14089
 No.17 McDONALD PLACE
 EVANS HEAD NSW
 DATE: 30/11/2023 REF: 220269-PL-AS-01
 SCALE: 1:200 @ A3 DRAWN: CD

© NEWTON DENNY CHAPELLE

